

ADJOINS SHEET 11

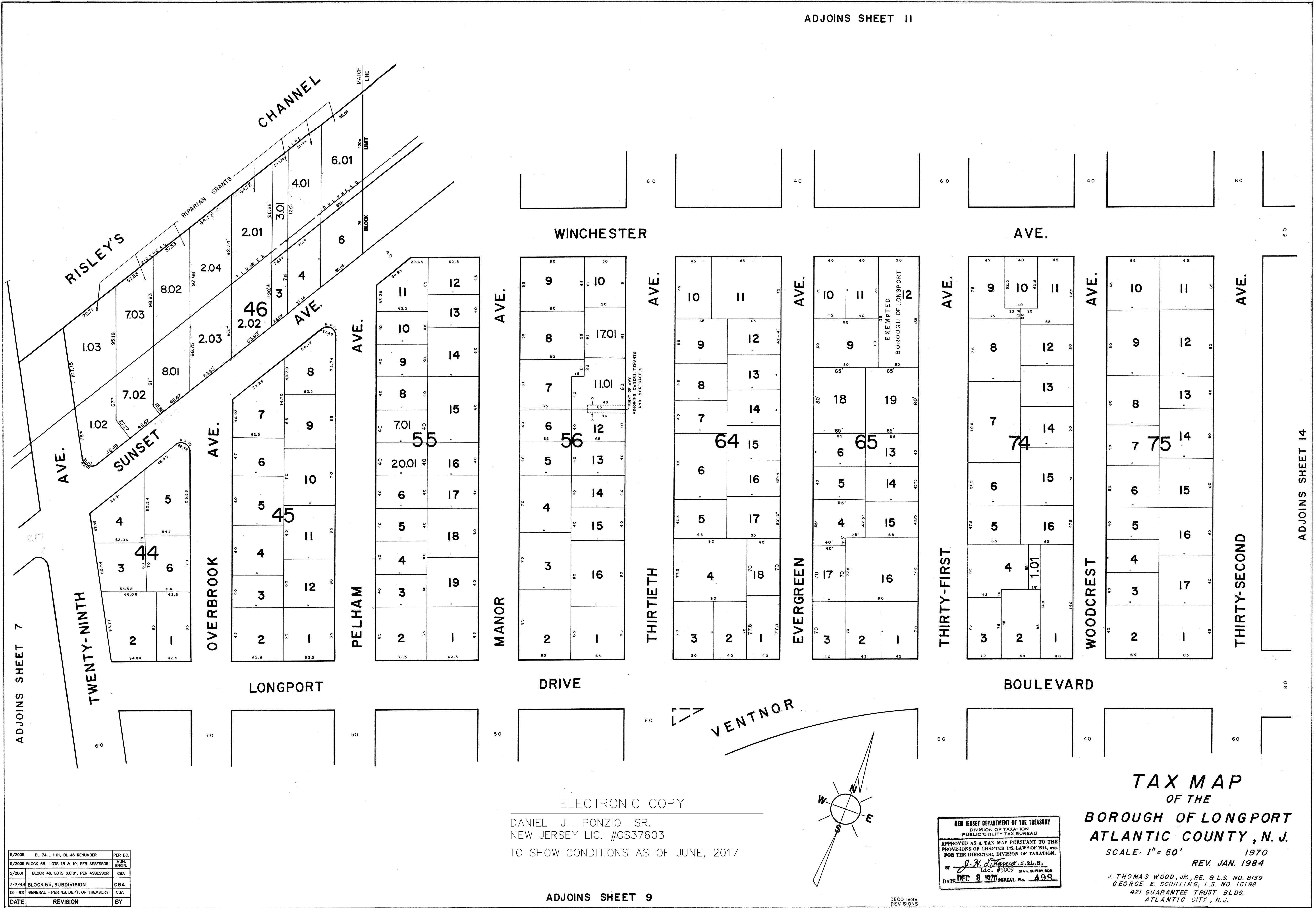

DATE	REVISION	BY
5/2005	BL 74 L 1.01, BL 46 RENUMBER	PER DC
5/2005	BLOCK 65 LOTS 18 & 19, PER ASSESSOR	KEAT ENUN.
5/2001	BLOCK 46, LOTS 6.01, PER ASSESSOR	CBA
7-2-93	BLOCK 65, SUBDIVISION	CBA
12-4-92	GENERAL - PER N.J. DEPT. OF TREASURY	CBA

ELECTRONIC COPY
 DANIEL J. PONZIO SR.
 NEW JERSEY LIC. #GS37603
 TO SHOW CONDITIONS AS OF JUNE, 2017

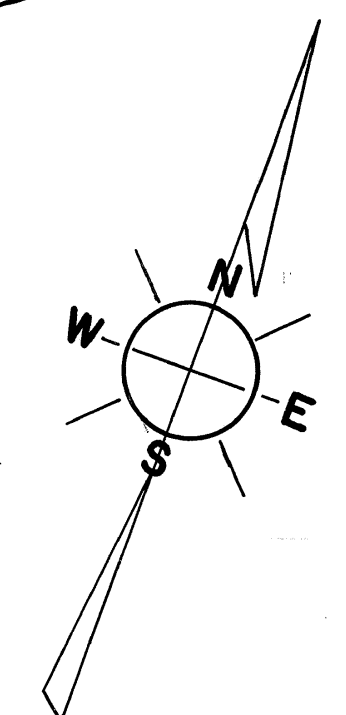

NEW JERSEY DEPARTMENT OF THE TREASURY
 DIVISION OF TAXATION
 PUBLIC UTILITY TAX BUREAU
 APPROVED AS A TAX MAP PURSUANT TO THE PROVISIONS OF CHAPTER 175, LAWS OF 1913, ETC. FOR THE DIRECTOR, DIVISION OF TAXATION.
 BY *J. N. Ponzio* E.L.S.
 LIC. #5009 STATE SUPERVISOR
 DATE DEC 8 1977 SERIAL NO. 493

TAX MAP
 OF THE
BOROUGH OF LONGPORT
ATLANTIC COUNTY, N.J.
 SCALE: 1" = 50' 1970
 REV. JAN. 1984
 J. THOMAS WOOD, JR., PE. & L.S. NO. 8139
 GEORGE E. SCHILLING, L.S. NO. 16198
 421 GUARANTEE TRUST BLDG.
 ATLANTIC CITY, N.J.

ADJOINS SHEET 9